

Boxing in pipes

Exposed pipework can be unsightly so you may want to find a way to hide them from view. Boxing them in is the best way of achieving this. It is important this is done in such a way that the pipes can be accessed in the event of a leak.

Method

- Measure the length of the pipes and cut a length of batten that is slightly wider than the depth of the pipes from the wall.
- Screw the batten vertically to the wall alongside the pipes using a spirit level to ensure it is level. Fit one-piece plastic joint blocks, 1m apart between the pipes and the batten.
- If the pipes are not in the corner of a room, you need to cut a second length of batten and screw it in position on the other side of the pipes.
- Measure the width between the outside edges of the batten and cut a piece of plywood or MDF to cover the batten and pipes. Fix it in place using screws or panel pins.
- Paint or cover the box with the relevant finish to match the surrounding wall decoration. If built correctly, the boxed in pipes should look like part of the wall.
- If the pipes run horizontally along the bottom of the wall. Follow the same method for boxing in vertical pipes, but remember the length of batten at ground level will need to be slightly slimmer than the batten above the pipes to accommodate the depth of the skirting board.

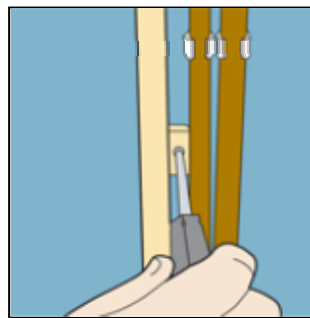

Fit one-piece plastic joint blocks 1m apart between the pipes and the batten.

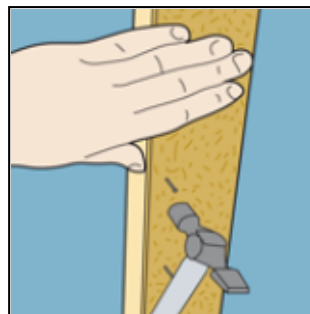

Fix the plywood or MDF in place using screws or panel pins.